

Muvento.

SMART CURTAIN ROBOT

(Remote control roman rod model)

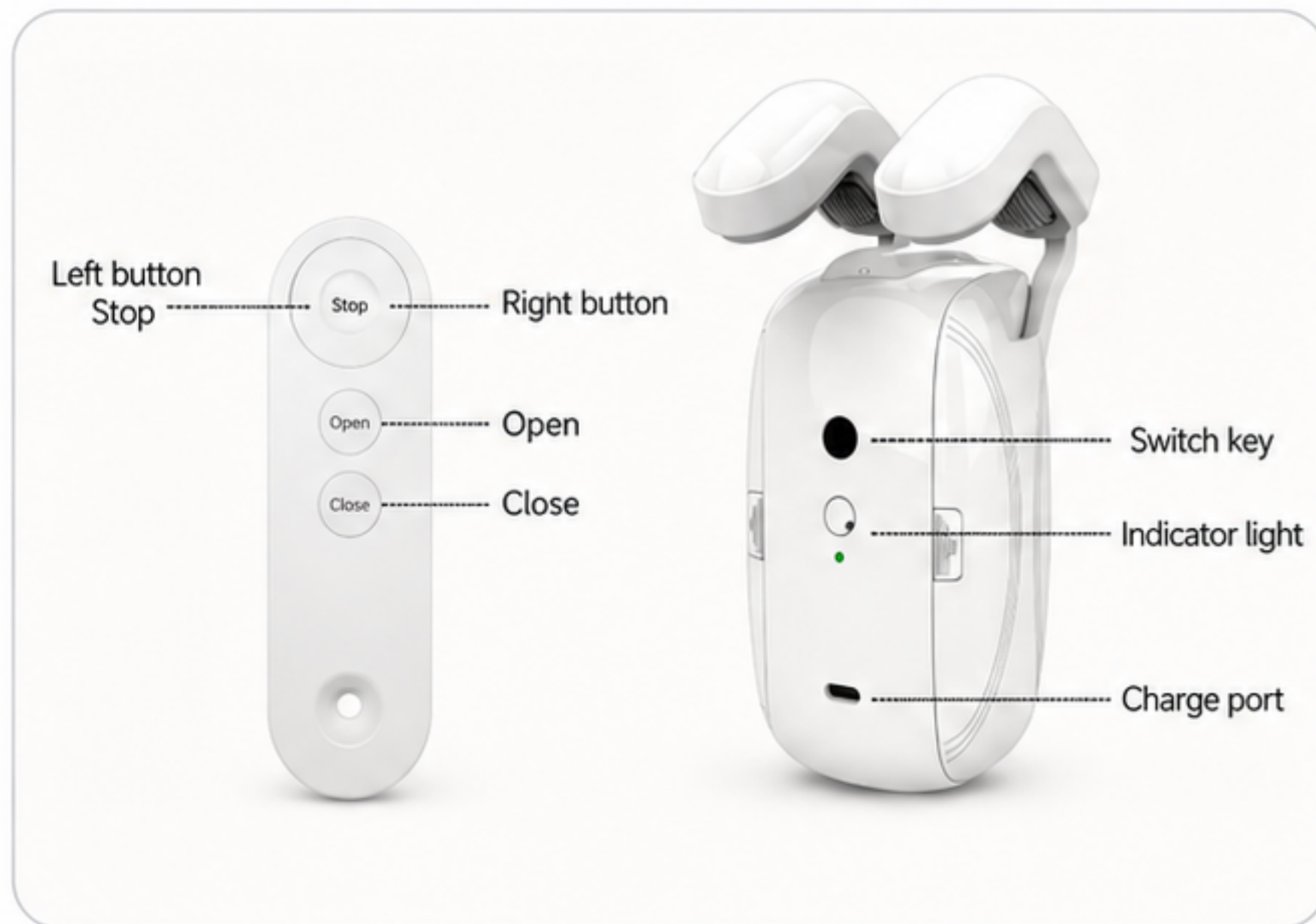

Accessories list



Curtain machine



Type-C



Remote control

Pairing method: 1. Long press the power button of the curtain machine for 3 seconds until the blue indicator light flashes slowly, press the "stop" button on the remote control, the blue indicator light of the curtain machine flashes quickly during pairing, and the pairing is successful when the light is off

The method of learning the stroke of the curtain machine: Press and hold the left and right buttons for 3 seconds and release them, press "Open" to open the curtains to the left / press "Close" to open the curtains to the right, that is, start learning, press "Stop" to stop

Roman Rod Installation Video:

<https://video.aliexpress-media.com/seller/play/5000519032936.mp4>

Network Connection & Travel Learning Video:

<https://video.aliexpress-media.com/seller/play/5000519124127.mp4>